

Tak fordi du har valgt Bell+

Jeg er virkelig glad for, at du har valgt at købe lampen Bell+, som jeg har designet for Darø. Lampen er designet med udgangspunkt i en dansk/skandinavisk designtradition kombineret med en nytænkning i forhold til funktion. Du har sikkert oplevet at Bell+ har et meget enkelt udtryk, hvor funktionen er meget let at aflæse. Lampen og lyset er ikke statisk. Bell+ kan vippes og drejes efter behov og skal være med til at inspirere til kreativ indretning.

Jeg håber, du bliver glad for din Bell+ og vil bruge den aktivt i mange år frem.

Thank you for choosing Bell+

I am really happy that you have chosen to purchase the Bell+ pendant which I have designed for Darø. The basis for the design of the lamp is the Danish and Scandinavian design tradition combined with an innovative perspective on function. You have probably noticed the simple look where the function is easily understood. The lamp and the light are not static. Bell+ can be tilted and turned as needed and is meant to inspire creative interior design.

I hope you will be pleased with your new Bell+ pendant and use it actively for many years to come.

Endnu en gang tak / Once again, thank you.

Thomas Holst Madsen
/Industrial designer



German
Design Award

AWARD 2014
DESIGN PLUS
powered by: light+building

SPECIAL
MENTION 2015

Samling / Assembly

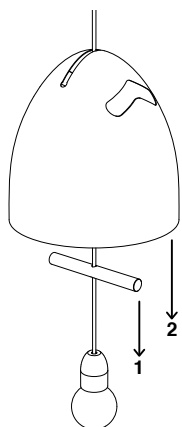

360° view

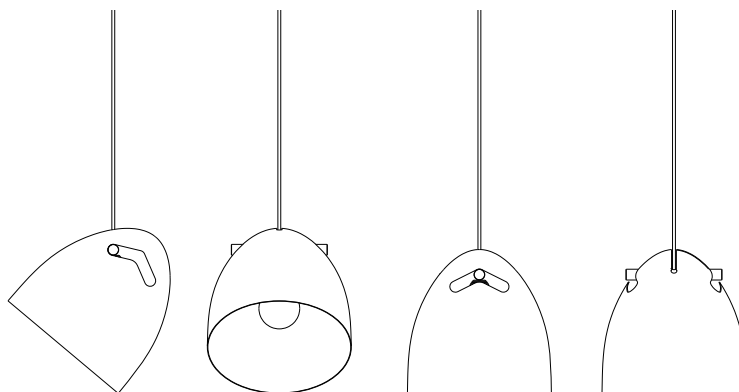

Drej / Turn

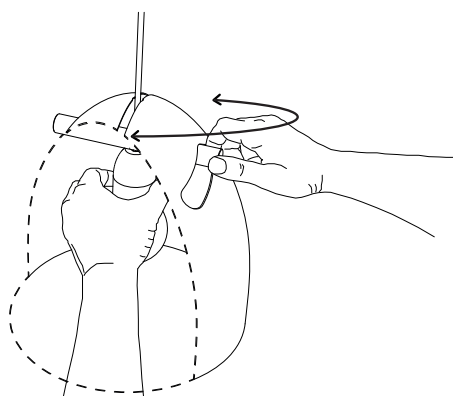

Vip / Tilt

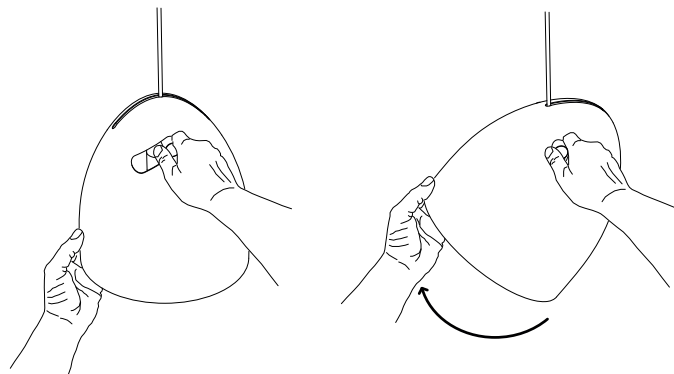

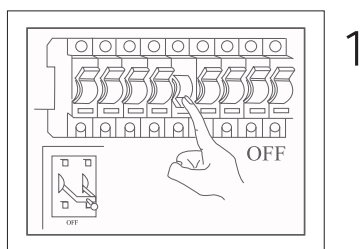

Afbryd strømmen før tilslutning!
Switch off the power before installation!

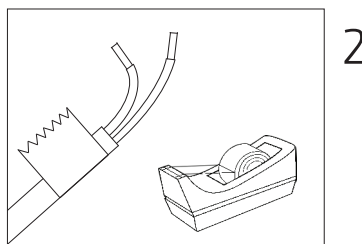

Forsegl tekstil med tape ved afkortning af ledning.
Seal the textile with tape when shortening the cord.

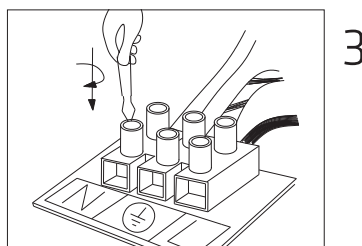

DA
Denne pendel er designet til montering direkte i loftudtag. Lampen kan også monteres i en loftbaldakin eller track-system.

EN
This pendant is designed to fit directly into the ceiling outlets. The lamp can also be mounted in a canopy or a track system.

LIGHT SOURCE
16 P1 max. 40W - G9 - 240V excl.

INSTALLATION
P1. Class II, 3m textile cable, incl. canopy

MATERIAL
Aluminium shade / oak bar

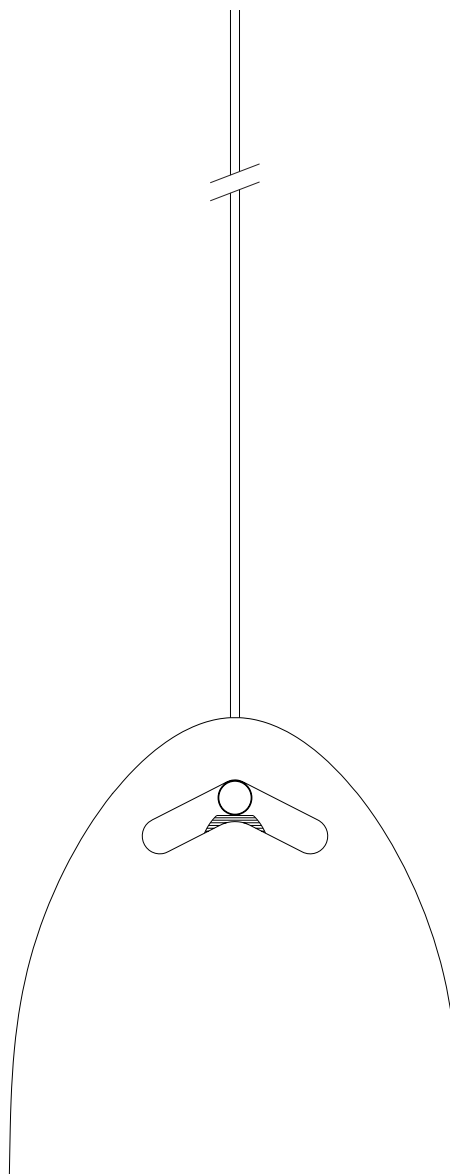

Beskyt miljøet / Protect the environment



Du kan hjælpe med at beskytte miljøet! Respektér venligst de lokale regler. Aflever det defekte elektriske udstyr på det lokale affalds-/genbrugscenter.
You can help protect the environment! Please respect the local rules: Pass the faulty electrical equipment at the local waste recycling center.

